

# ARCADE MALL

1332 MAIN STREET





## Availabilities

### SECOND FLOOR

**Suite 201:** ± 2,251 RSF

**Suite 207:** ± 212 RSF

**Suite 226:** ± 2,211 RSF

### LEASE RATE

\$21.00 per RSF / Full Service

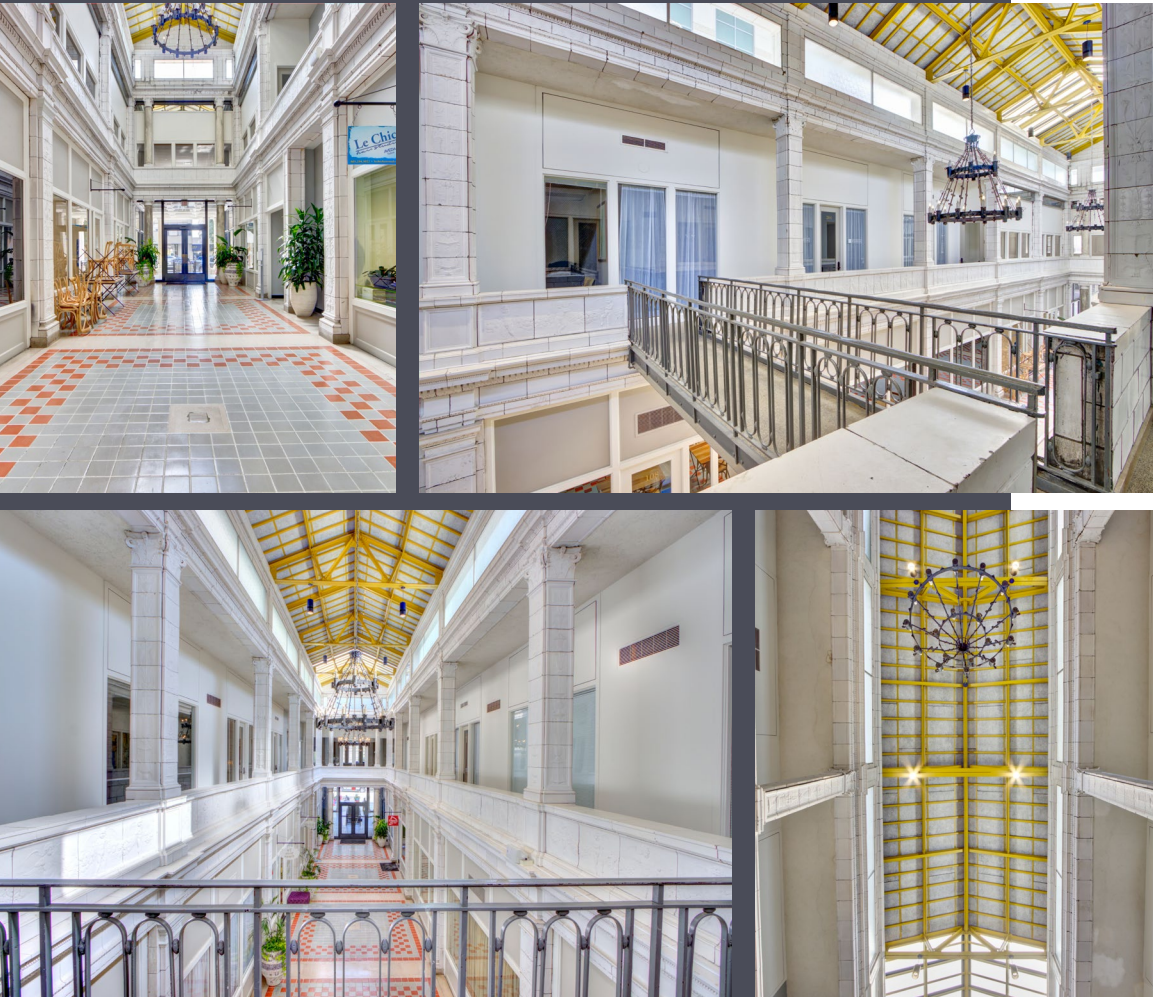

**ARCADE MALL**  
**1332 MAIN STREET**

## History

The Arcade Mall was originally constructed in 1912 as Columbia's first indoor shopping center, inspired by open arcades seen in Europe.

## Building Information

The Arcade Mall is located in the heart of downtown Columbia with entrances on Main Street and Washington Street. The historic building contains high-end finishes with a variety of floor plans.

## Tenants

The building features over thirty (30) co-tenants split between two (2) floors. Various tenants include TakoSushi, Swanson's Deli, Ally & Eloise Bakery, Stoner's Pizza Joint, and Odd Bird Books.

## Additional Information

[Click here](#) for more information.



Professional Elegance



Virtual Tour

LOBBY AND COMMON AREAS

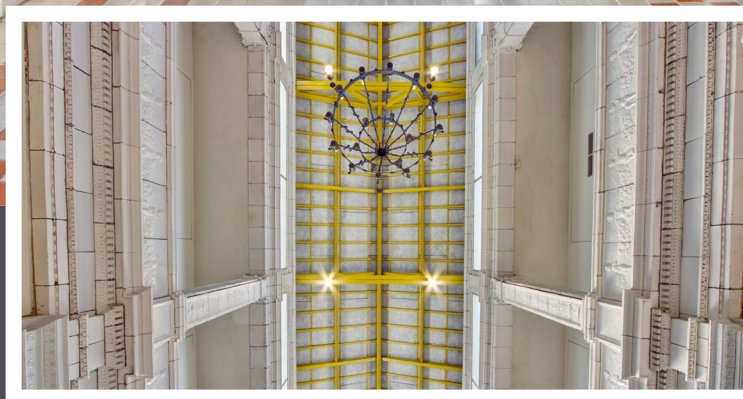

**ARCADE MALL**  
**1332 MAIN STREET**





**ARCADE MALL**  
**1332 MAIN STREET**



# Floorplan

FIRST FLOOR

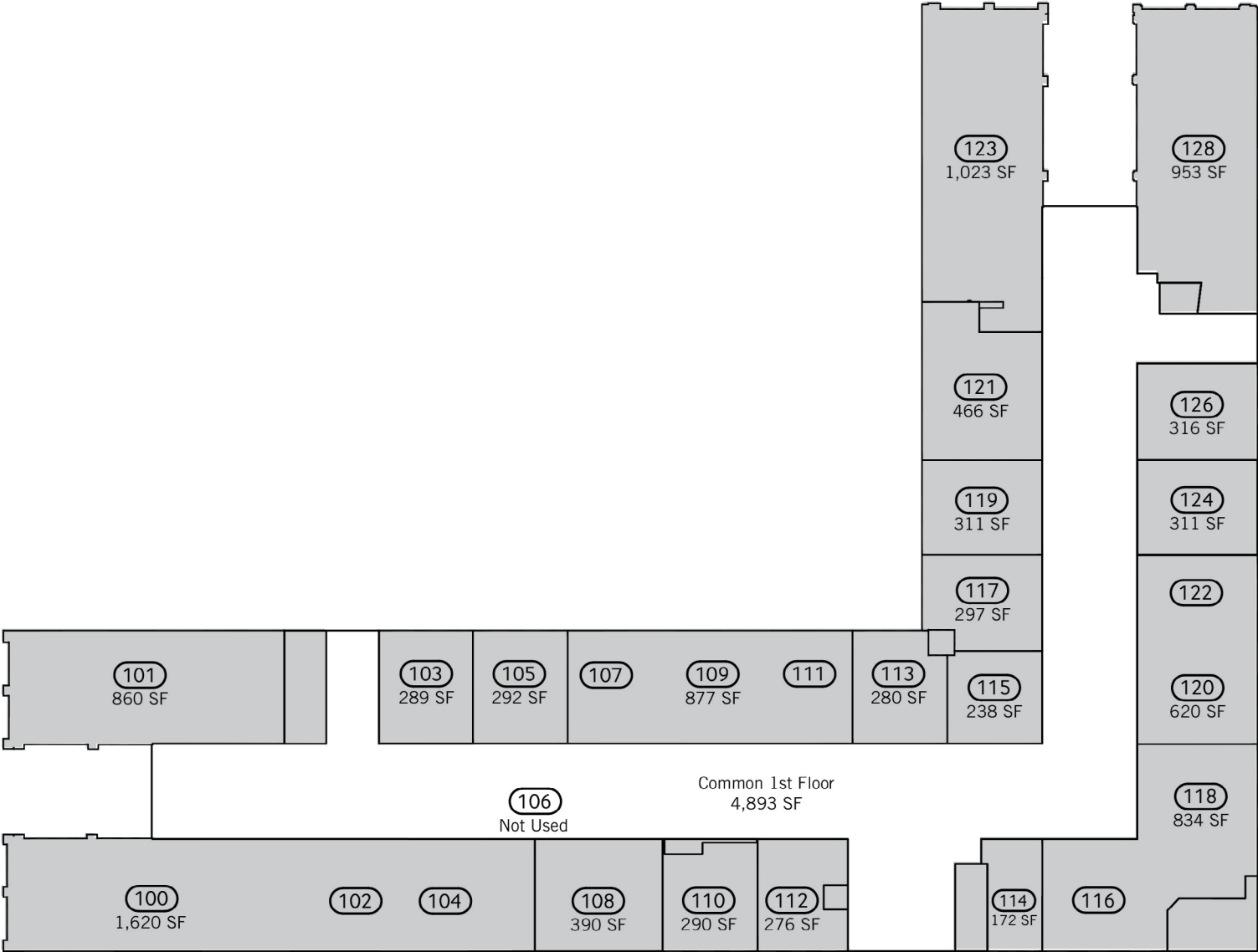

**ARCADE MALL**  
**1332 MAIN STREET**

# Floorplan

SECOND FLOOR

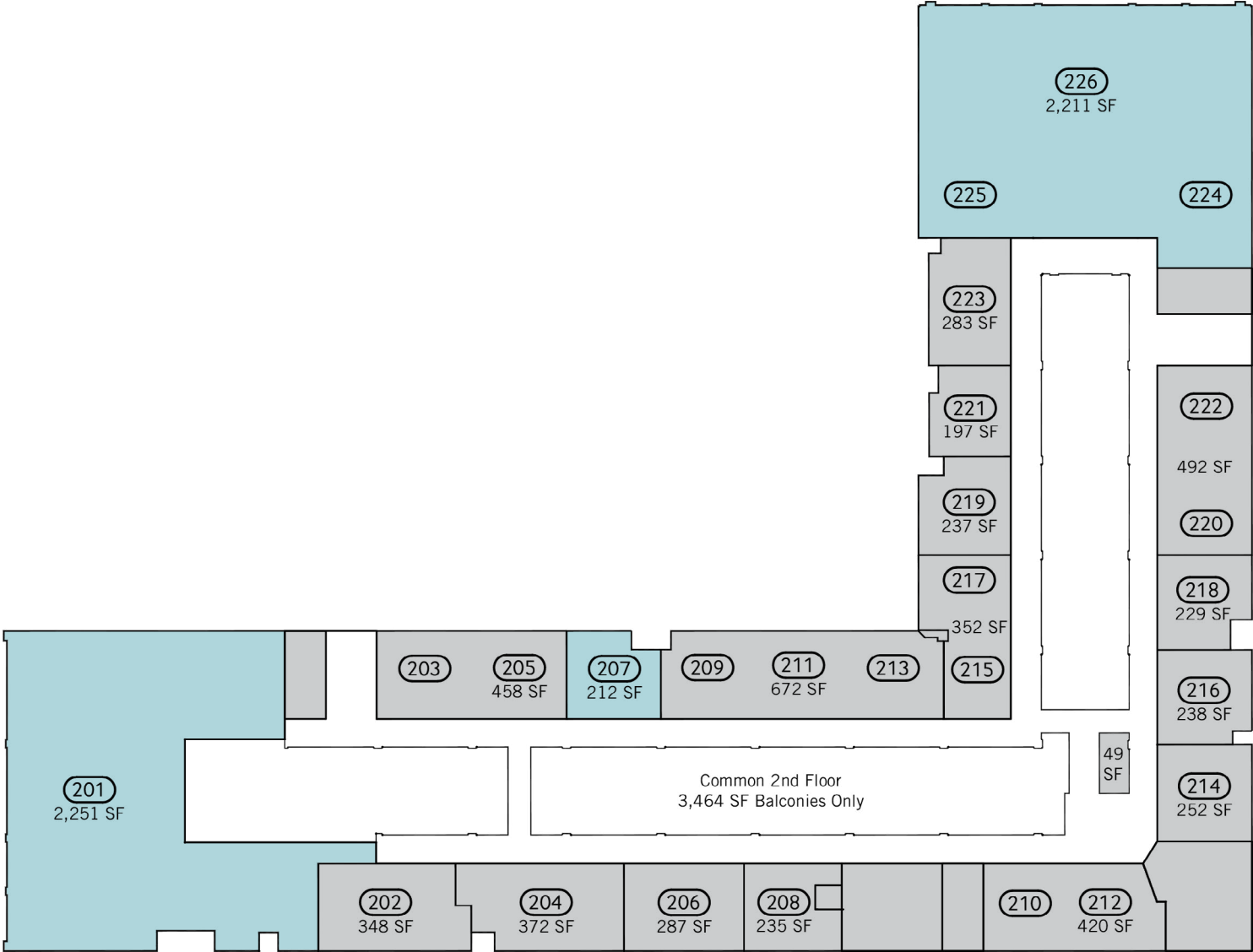

**ARCADE MALL**  
**1332 MAIN STREET**

# ARCADE MALL

1332 MAIN STREET

## CONTACT INFORMATION

**Roger Winn, SIOR**

[rwinn@trinity-partners.com](mailto:rwinn@trinity-partners.com)

803-567-1455

**Braden Shockley**

[bshockley@trinity-partners.com](mailto:bshockley@trinity-partners.com)

803-567-1373

**TRINITY  
PARTNERS**

1332 MAIN STREET, COLUMBIA, SC 29201 | [TRINITY-PARTNERS.COM](http://TRINITY-PARTNERS.COM)